

This document must not be copied, either completely or in part, without permission. Any infringement will have legal consequences ©

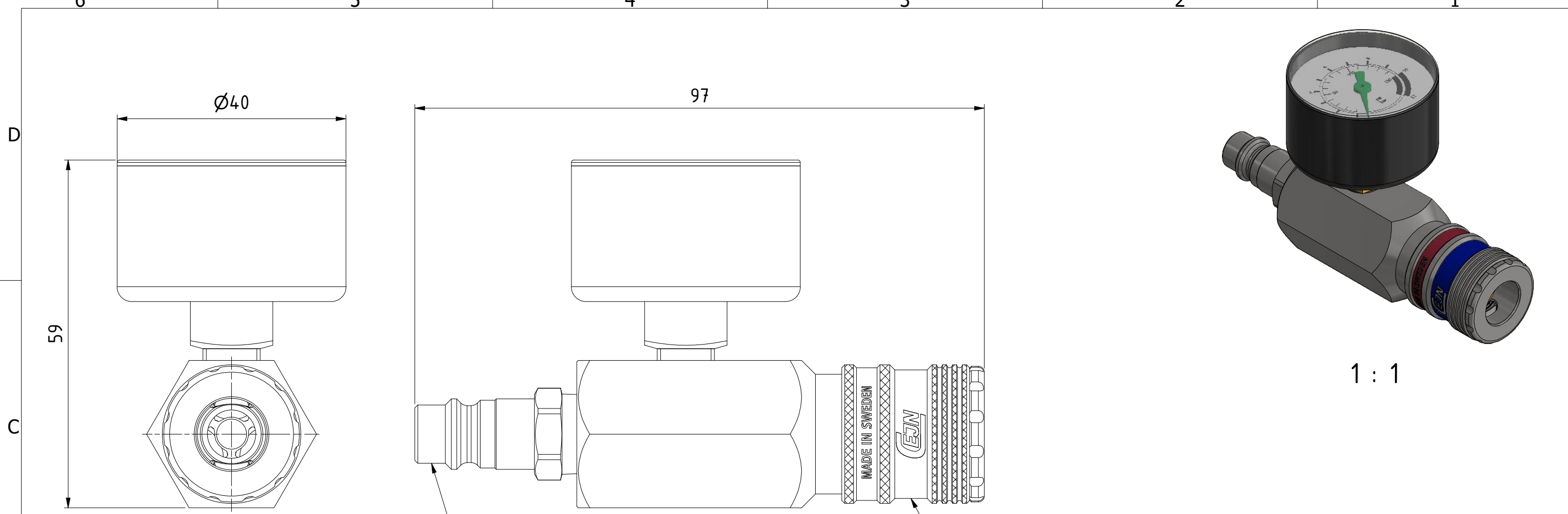

Pressure range 0-12 bar (0-175 PSI)

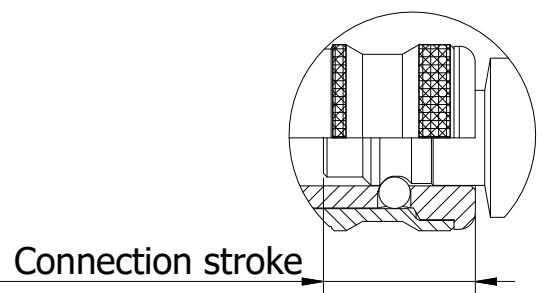

Product No.	199009102
Nominal flow \varnothing DN:	7,6 mm
Connection Stroke:	19,2 mm
Max WP Connected:	12 bar
Min BP Connected:	bar
Temperature range:	-20°C - +100°C
Connection:	See drawing
Sealing material:	NBR
Hexagon:	25

13	1	Pressure gauge	Plastic and Brass
12	1	Nipple	Hard. Steel FeZn 8 P1
11	1	Spring	Stainless steel
10	1	Spring	Stainless steel
9	1	Lip seal	NBR
8	1	Valve seat	Brass
7	1	O-ring	NBR
6	1	O-ring	NBR
5	1	Valve	Brass
4	1	Locking sleeve	Hard. steel, Zn 8 Silver
3	2	Hook	Hard. Steel, Zn-Ni 8 transp.
2	1	Front part	Hard. Steel, Zn 8 silver
1	1	Back part	Brass, CuNi5b
Item	Qty	Description	Material
		Scale: 3 : 2	Drawn: CABANLA
		Checked: LHE	Appr.: JOOL
		ECO	
		Date: 2020-03-26	
		Drawing No. 509009102	
		Issue: AB	Sheet: 1 / (1)



Assembly Drawing 509009102

